

GT30 PERFORMANCE CRUISER

PRINCIPAL PARTICULARS:

LOA	9.14 m	30' 0"
LWL	8.69 m	28' 6"
Beam	3.4 m	11' 2"
Draught [Bilge Keels]	1.35 m	4' 5"
Draught	TBC	
Displacement	5,500 kg	12,250 lb
Lead Ballast	2,220 kg	4,900 lb
Sail Area	50 m ²	539 ft ²

PRELIMINARY FIGURES

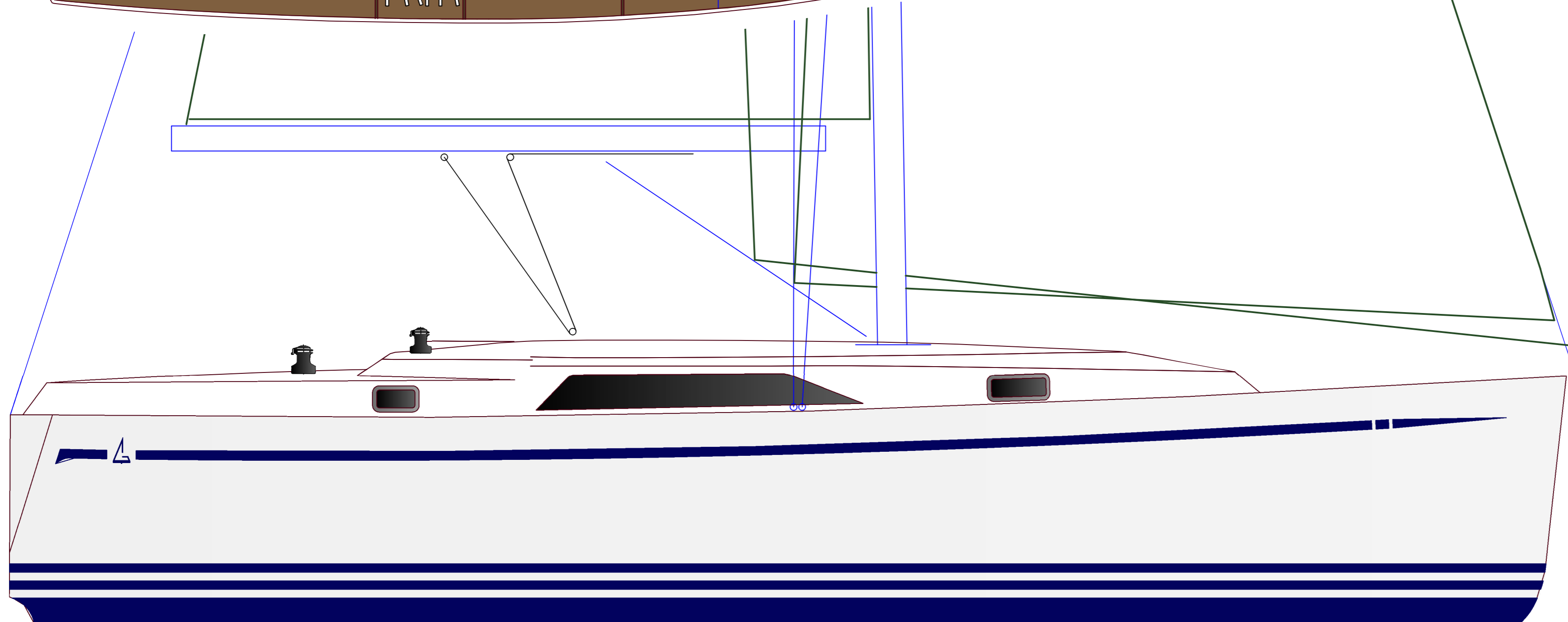
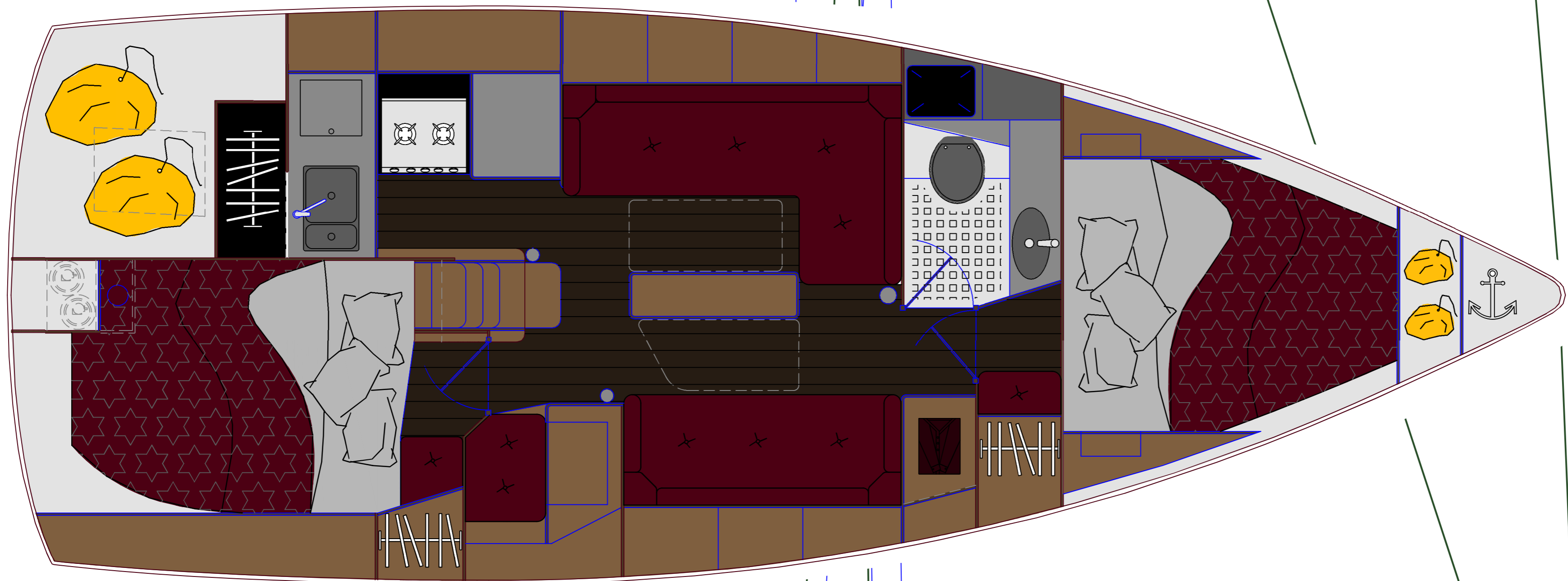
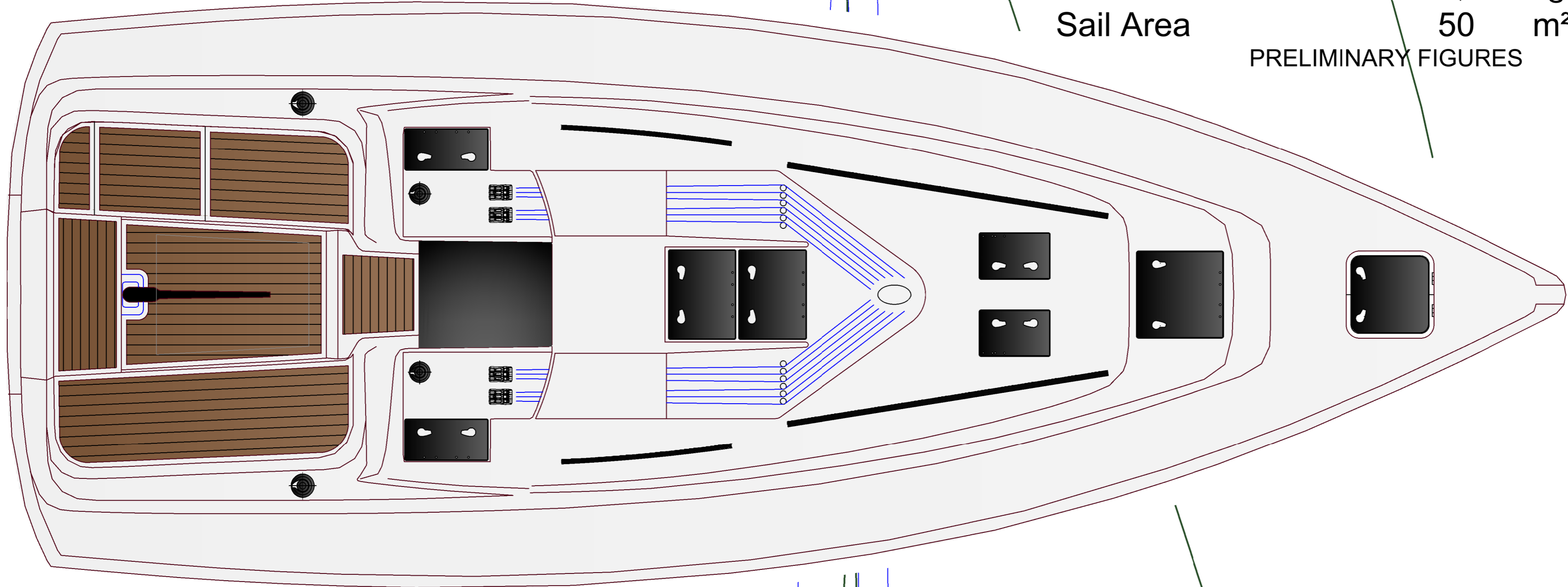

WicorMarine Yacht Haven
Cranleigh Road
Portchester
Hampshire
PO16 9DR
UK

tel +44 (0)1730 26 45 48
email info@gyachts.com
web www.gyachts.com

GT YACHTS

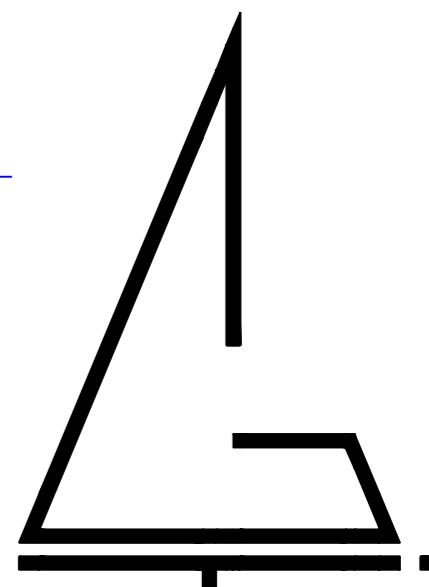

yacht : GT30		checked by		checked date
title : General Arrangement - Plan and Profile		SJ		30/05/2014
drawing number : GT0400X-601		all dimensions in 'mm' unless otherwise stated general tolerance 1.0 mm & 0.5 degree unless otherwise stated		
drawn by : CLC	Scale 1:20 @ A1	Issue D	sheet 1 of 1	

COMMERCIAL IN CONFIDENCE THIS DRAWING DOCUMENT IS CONFIDENTIAL AND MUST NOT BE REPRODUCED FOR MANUFACTURE OR COPIED OR COMMUNICATED TO ANY OTHER PERSON OR COMPANY WITHOUT THE EXPRESSION OF GT YACHTS LTD.